



CE 1434

COVID-19 (SARS-CoV-2) Antigen Test Kit (Colloidal Gold) - Saliva

Self-testing



Anhui Deepblue Medical Technology Co.,Ltd.
Website:www.dbluemedical.com
Address:4th Floor D-1# Zone, Pearl Industrial Park 106
Innovation Avenue,High-Tech Development Zone 230088 Hefei,
Anhui, China





1 pc / box, 10 boxes / medium box, 45 medium box (450 Tests) / carton
Box size : 145*65*20mm
Medium box size : 205*150*68mm,
Carton size: 63.5*47.5*36.5cm, G.W. 18.5kg

German version: 1pc/box, 800pcs/carton, carton size: 61*54*55cm, G.W. 24.5KG

5 pcs / box 200 boxes /carton --1000 Tests /carton
Box size : 130*70*52mm
Carton size: 55*54*37cm, G.W. 17.5kg

25 pcs / box 50 boxes /carton --1250 Tests /carton
Box size : 260*120*75mm
Carton size: 62*54*40cm, G.W. 22.5kg



Your kit contains the following materials

Box

IFU

Saliva swab

Test device

Collection bag

Antigen Extraction Tube



CE 1434

COVID-19 (SARS-CoV-2) Antigen test kit (Colloidal Gold) - Saliva (Self-Testing)

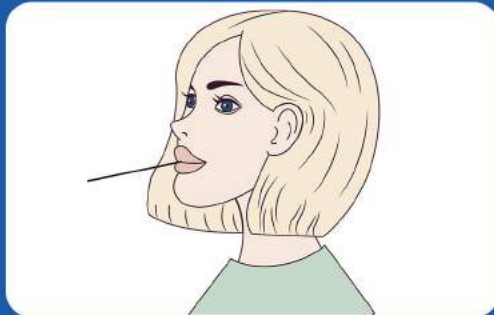

Specification	1 pcs/box 5 pcs/box 25 pcs/box
Specimen	Human Saliva
Storage	4~30°C

PERFORMANCE

SENSITIVITY: 98.7% (95% CI: 92.33% - 99.07%)

SPECIFICITY: >99.9% (95% CI: 98.17% - 100%)



PRODUCT FEATURES

- ◆ Room temperature storage.
- ◆ No need instrument, get results within 15 minutes.
- ◆ Identify acute or early infection.
- ◆ No reduction in sensitivity test against the UK, South African, Brazilian and Delta variant.

UK GOVERNMENT VALIDATED

The UK Government Public Health England, joint PHE Porton Down and University of Oxford was independently evaluated over 140 lateral flow devices that have been referred by the Department of Health and Social Care (DHSC) . Only a few can passed the phase 3A trials, and our DEEPBLUE even have passed phase 3B. That means our test has very high accuracy at multiple viral loads and able to detect the asymptomatic patients and the new different variants.

Easy to use

Using a saliva swab to collect the specimen in mouth, just like a lollipop.



Scan the following QR code to watch the demonstration video on YouTube.



Your kit contains the following materials



option 1 option 2



IFU

Saliva swab

Waste bag

Test device

Antigen Extraction Tube

TEST PROCEDURE

1. Specimen Collection

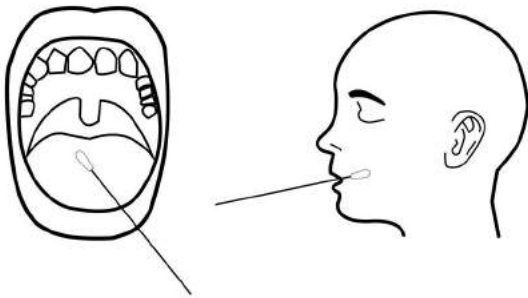

2. Specimen Preparation

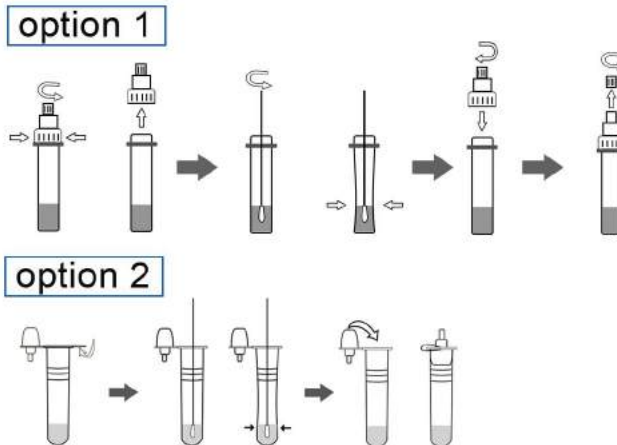

3. Testing

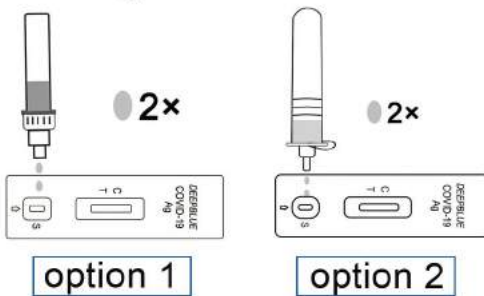

Hold the extraction tube vertically and add two drops of the test specimens into the specimen well (s). Start the timer. Interpret the results at 15 minutes, and the results after 30 minutes are no longer valid.

4. Interpretation of test results

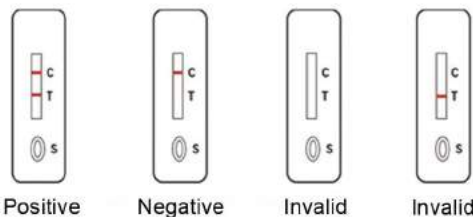

ANHUI DEEPBLUE MEDICAL TECHNOLOGY CO.,LTD.

【Address】 4th, Floor, D-1# Zone, Pearl Industrial Park, 106 Innovation Avenue, High-Tech Development Zone, Hefei 230088, Anhui, China

【Website】 www.dbluemedical.com