

set up
guide



simplehuman®

In just a few easy steps,
your new wall mount
pumps will be **ready
to go**. We'll show you
exactly what to do in
this guide.

what's in the box...



wall plate



2 pumps

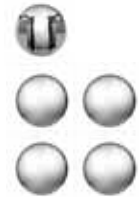

5 side caps



waterproof glue

1 find a good spot

- Clean the selected area with rubbing alcohol. If you don't have any, just use water.
- Make sure the area is **completely dry** before you start.

2 prepare the wall plate

Tip: Don't just use the tape! The tape holds the plate in place while the glue dries—it's not strong enough to use on its own.

- Apply the glue as shown so everything but the outer rim is covered with glue. You want a strong hold, so use the entire tube.

- **Do not** apply glue over the tape.

Don't skimp. Use up ALL the glue!



NOTE: The wall plate can also be **installed with screws**. Skip ahead to find out how.

3 mount the wall plate

- Peel the backing off the double-sided tape on the back and press the wall plate firmly against the wall. Either use a level or eyeball it to make sure it's level.
- Wait **24 hours**. If you try to attach the pumps too soon, the glue won't hold.

Tip: Don't worry about excess glue. It's easy to peel away once it's dry.

Make sure the logo is right-side up!

Wait 24 hours



4 attach the pump

- Snap the side caps into each pump.

Tip: There's an extra cap with a hook. If you want to use the hook, think about which side of the pump will be easier to access in the shower.



- Align the back pegs of the pump with the holes on the wall cover.

Push down all the way so that unit locks in place.

optional: mount with screws

Since you'll need to drill into your tiles, we recommend this only for serious do-it-yourselfers or professionals.



- Pry the wall plate open with a screwdriver.

Tip: Use the screw holes on the back plate as a guide to mark the wall for drilling.

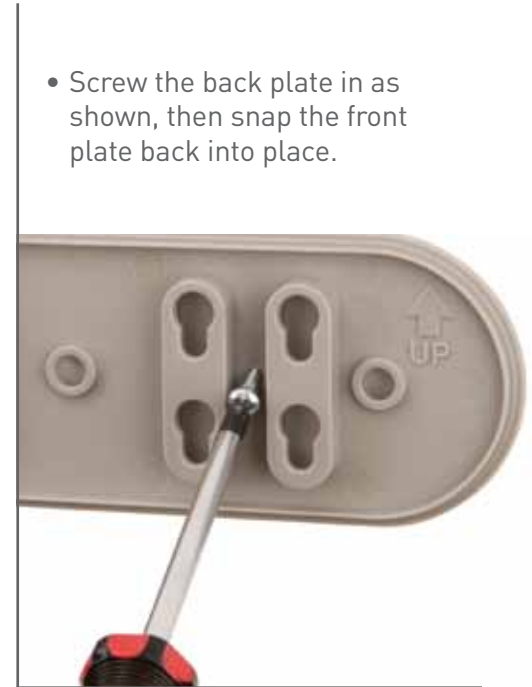

- Screw the back plate in as shown, then snap the front plate back into place.

A photograph of three wall-mounted soap dispensers in a bathroom. The dispensers are silver and mounted on a wall with light-colored tiles. The leftmost dispenser contains white soap, the middle one contains white soap, and the rightmost one contains blue liquid. A window is visible in the background.

use & care

- If you want to clean the pumps while they're still on the wall, just fill them with water and then pump until all the water is gone. Then pour in new shampoo or soap.
- You can also remove the pump and clean it with warm, soapy water.
- Do not use abrasive or chemical cleaners and do not put the pumps in the dishwasher.
- Please note that soaps with exfoliants or moisture beads may clog the pumps.

Questions?

Find answers easily online:

www.simplehuman.com/service

shower smart with our caddy collection

new

Our **adjustable bathtub caddy**
holds everything at an easy
reach for a long, relaxing bath.

see the entire collection at www.simplehuman.com



tension shower caddy



adjustable shower caddy



plastic adjustable
shower caddy



corner shower caddy

a perfect fit for every shower or bath

Whether you have a tiny stall
shower or a super-wide tub,
our caddies are designed to
best fit your needs.

← tools for efficient living®

www.simplehuman.com